

Mounting instructions for BV2.0 walk-in accessories

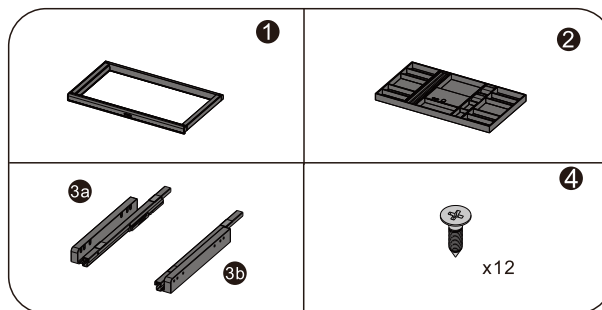

Slides installation

1.1 Drilling Ø2.5 mm

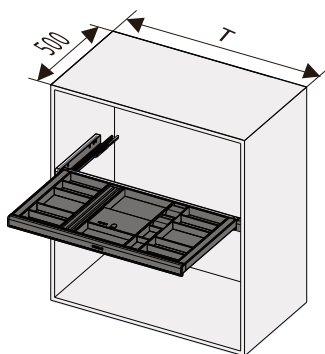
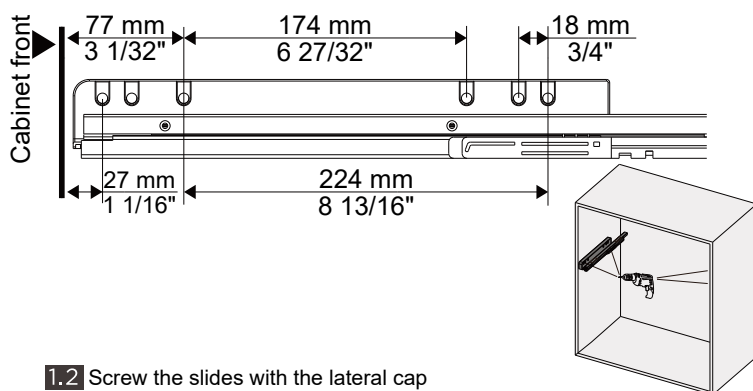

1.2 Screw the slides with the lateral cap

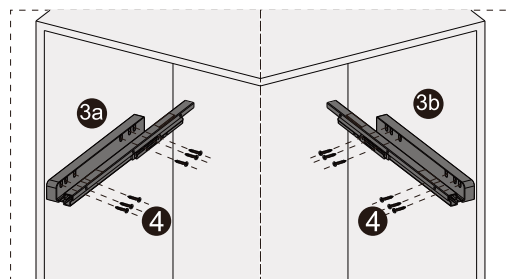

Frame installation

2.1 Tilt up the back of the frame

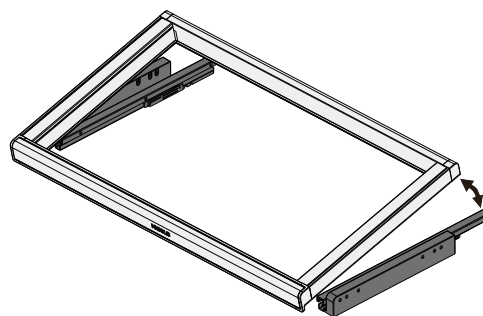

2.2 Position the rear section of the front of the frame onto the front of the slides, then lower the back of the frame until it locks completely.

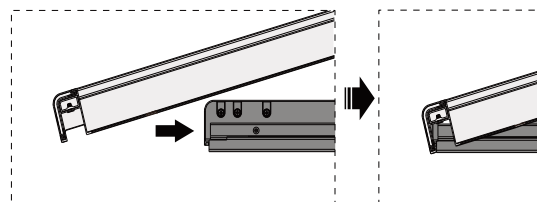

Interior layout installation

